

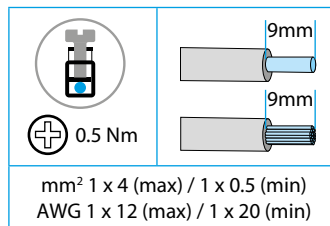

## 78.1B

<b>IN</b>	<b>78.1B.1.230.2403</b> $U_N$ (120...240)V AC (50/60 Hz) $U_N$ 220 V DC $U_{min} - U_{max}$ 100 - 265 V AC (50/60 Hz) $U_{min} - U_{max}$ 140 - 275 V DC $P_{(stand-by)} < 1$ W
<b>OUT</b>	- [IN 230 V AC, (-20...+40)°C] 5 A (max 10 A - 5 ms) 24 V DC, 120 W - [IN (100...275)V, 40°C] 4.5 A (max 10 A - 5 ms), 24 V DC, 110 W
	(-20...+70)°C
IP20	



78	$U_N$	LED
OK	✓	
Sh	✓	15s. OFF
ThL	✓	OFF

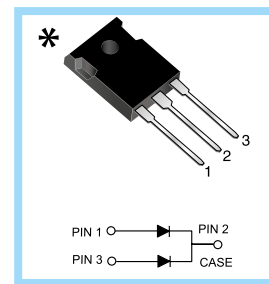
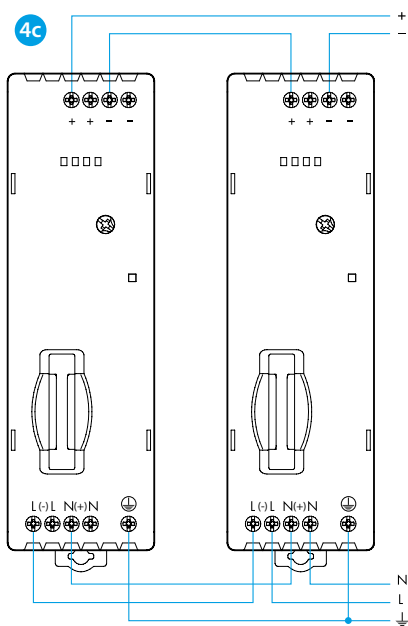
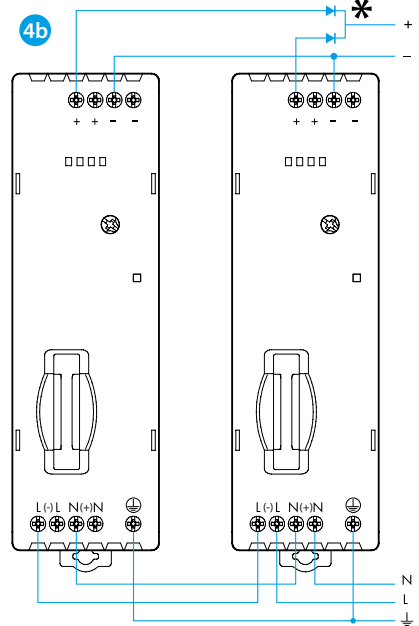
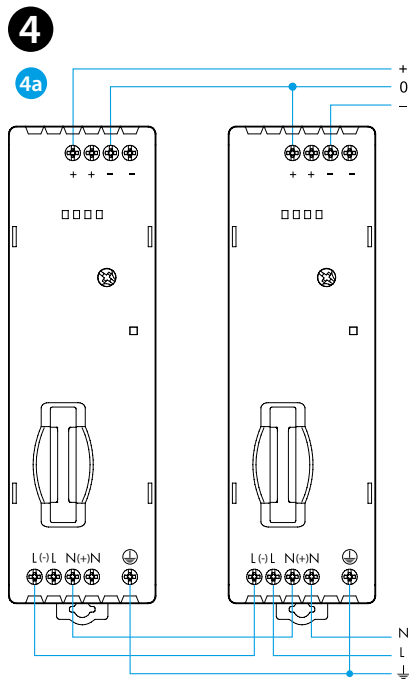
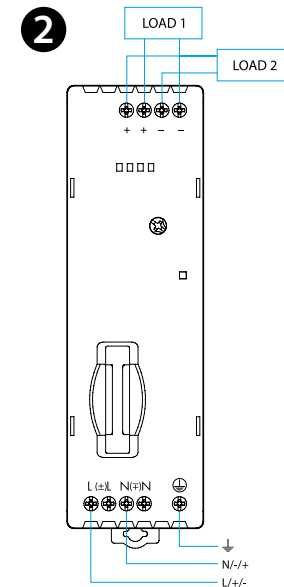
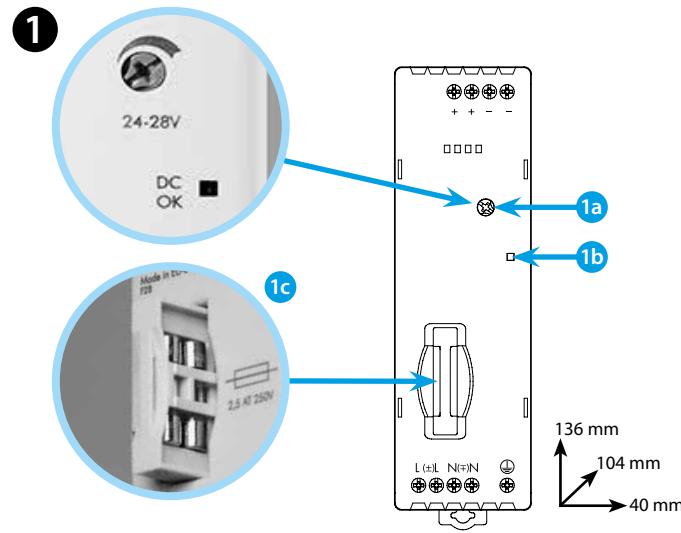

**UL US LISTED**  
 IND. CONT. EQ.  
 E361251

Input 115 V AC 50/60 Hz / 1.65 A  
 Output 24 V DC, 4 A / 96 W  
 Input 230 V AC 50/60 Hz / 1.1 A  
 Output 24 V DC, 4.5 A / 108 W

- Open Type Equipment - Pollution Degree-2 Installation Environment
- Maximum Surrounding Air Temperature 40°C
- Use 60°C / 75°C copper (CU) conductor and wire ranges No. 14-18 AWG, stranded or solid
- The terminal tightening torque of 0.5 Nm

A readily accessible disconnect device shall be incorporated in the building installation wiring:

- Circuit breaker 6 A Z-curve
- Input fuse 3.15 A - T - F1
- Equipment intended for installation in restricted access location

# ESPAÑOL

## 78.1B FUENTES DE ALIMENTACION CONMUTADAS

- 1 DIMENSIONES / VISTA FRONTAL**  
 1a Regulador de tensión de salida de 24 a 28 V DC  
 1b LED de señalización del estado de la salida  
 1c Fusible de protección en la entrada (fusible de repuesto incluido)

## 2 ESQUEMAS DE CONEXIÓN

### 3 INDICACIÓN LED Y FUNCIÓN

- $U_N$  Alimentación AC/DC
- Sh Cortocircuito
- ThL Límite térmico
- Led (1b) LED Verde

### 4 EJEMPLOS DE CONEXION

- 4a Conexión Dual
- 4b Conexión en paralelo ( $I \leq 2 \times I_N$ )  
 \* MBR 4060PT (TO247)
- 4c Conexión en serie

### NOTA

- Rendimiento: 93% @ 230 V AC
- Protección automática al corto circuito